

---

***ITALGROUP SRL***  
***IAM SERIES - IAM H45***  

---

***GENERAL CATALOGUE***  

---

***INDEX - IAM H45***

<u>IAM H45 - INSTALLATION DRAWING</u>	Pag	112 - 113
<u>IAM H45/C - INSTALLATION DRAWING</u>	"	114 - 115
<u>IAM H45 - PERFORMANCE DRAWINGS</u>	"	116 - 118
<u>IAM H45 - ORDERING CODE</u>	"	119

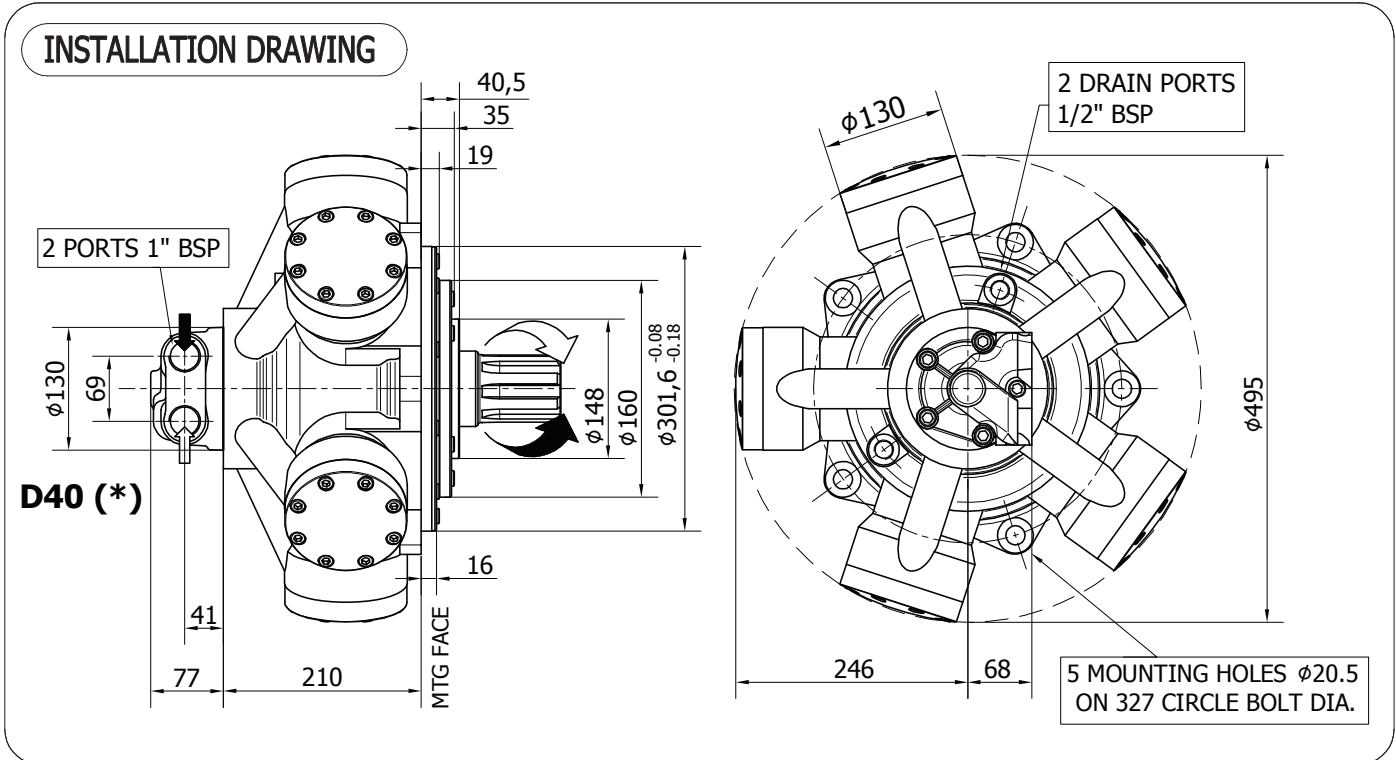

**TECHNICAL DATA**

		<b>1100</b>	<b>1400</b>	<b>1600</b>	<b>1800</b>
DISPLACEMENT	[cc]	1183	1376	1648	1815
SPECIFIC TORQUE	[Nm/bar]	18.8	21.9	26.2	28.9
MAX. CONT. PRESSURE	[bar]	250	250	250	250
HYDROSTATIC TEST PRES-SURE	[bar]	420	420	420	420
MAX. CONT. SPEED	[rpm]	350	300	275	250
PEAK SPEED (***)	[rpm]	400	350	325	300
MAX. CONT. POWER (****)	[kW]	85	85	85	85
MAX. POWER	[kW]	120	120	120	120
MAX. CASE PRESSURE	[bar]	6	6	6	6
DRY WEIGHT	[kg]	118	118	118	118
TEMPERATURE RANGE (**)	[°C]	-30÷70	-30÷70	-30÷70	-30÷70

- (\*) The standard distributor (D40) is shown. Please refer to distributors section (pag. 176-177) for different distributor interfaces.
- (\*\*) Please refer to the hydraulic fluid recommendations (pag. 10-11).
- (\*\*\*) Do not exceed maximum power (see pag. 13).
- (\*\*\*\*) For motor operation with a continuous duty cycle at maximum continuous power the flushing is usually required. For more information please contact our technical department.

The data specified into the catalogue are for product description purpose only and must not be interpreted as warranted characteristics in legal sense. Italgrou S.r.l. reserves the right to implement modifications without notice. All partial or total reproduction and copy without written authorization of Italgrou S.r.l. is strictly forbidden.

SHAFT CONFIGURATIONS

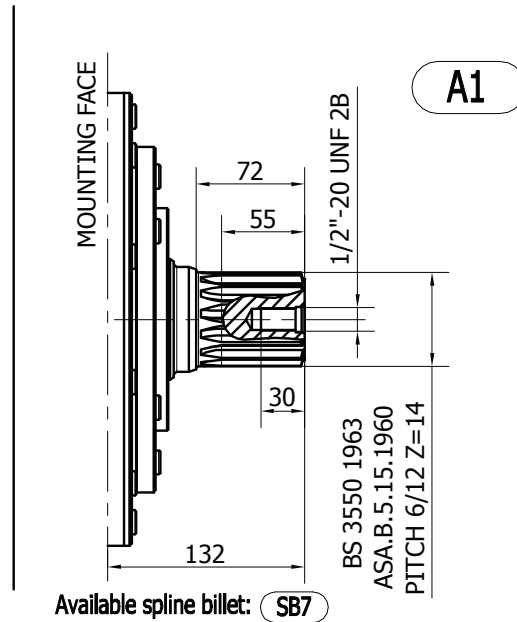
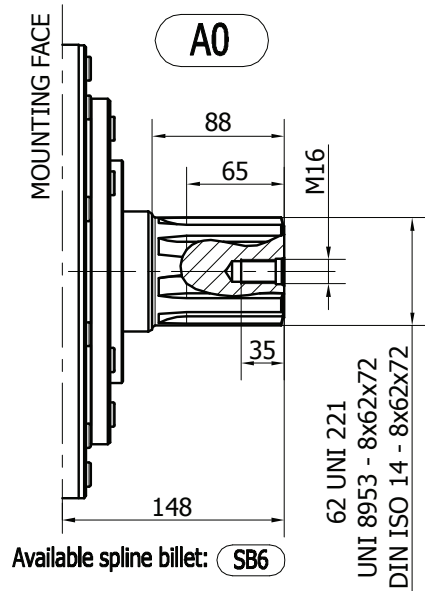

**INSTALLATION DRAWING**

Available distributor flange: **FL4**  
refer to page 184 (distributor fitting D75)

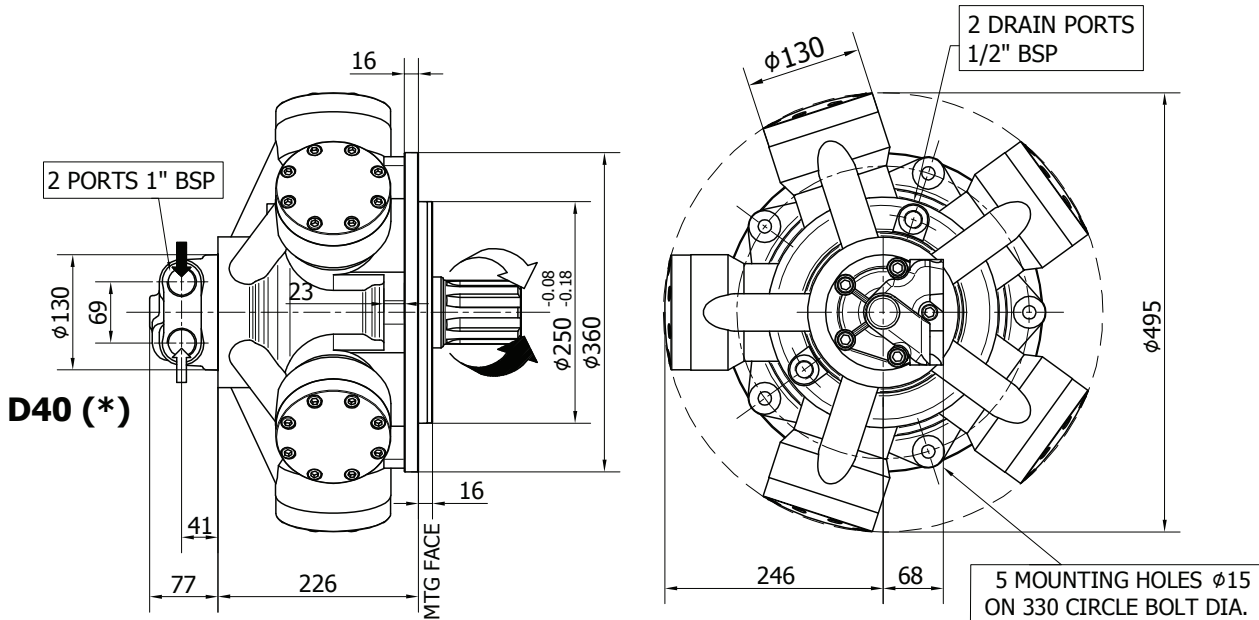

**TECHNICAL DATA**

		<b>1100</b>	<b>1400</b>	<b>1600</b>
DISPLACEMENT	[cc]	1183	1376	1648
SPECIFIC TORQUE	[Nm/bar]	18.8	21.9	26.2
MAX. CONT. PRESSURE	[bar]	250	250	250
HYDROSTATIC TEST PRESSURE	[bar]	420	420	420
MAX. CONT. SPEED	[rpm]	350	300	275
PEAK SPEED (***)	[rpm]	400	350	325
MAX. CONT. POWER (****)	[kW]	85	85	85
MAX. POWER	[kW]	120	120	120
MAX. CASE PRESSURE	[bar]	6	6	6
DRY WEIGHT	[kg]	118	118	118
TEMPERATURE RANGE (**)	[°C]	-30÷70	-30÷70	-30÷70

- (\*) The standard distributor (D40) is shown. Please refer to distributors section (pag. 176-177) for different distributor interfaces.
- (\*\*) Please refer to the hydraulic fluid recommendations (pag. 10-11).
- (\*\*\*) Do not exceed maximum power (see pag. 13).
- (\*\*\*\*) For motor operation with a continuous duty cycle at maximum continuous power the flushing is usually required. For more information please contact our technical department.

The data specified into the catalogue are for product description purpose only and must not be interpreted as warranted characteristics in legal sense. Italgrou S.r.l. reserves the right to implement modifications without notice. All partial or total reproduction and copy without written authorization of Italgrou S.r.l. is strictly forbidden.

SHAFT CONFIGURATIONS

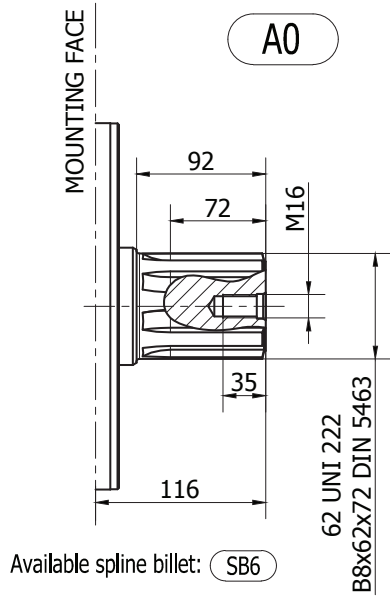

## IAM H45 - PERFORMANCE DIAGRAMS

### 1100 cc

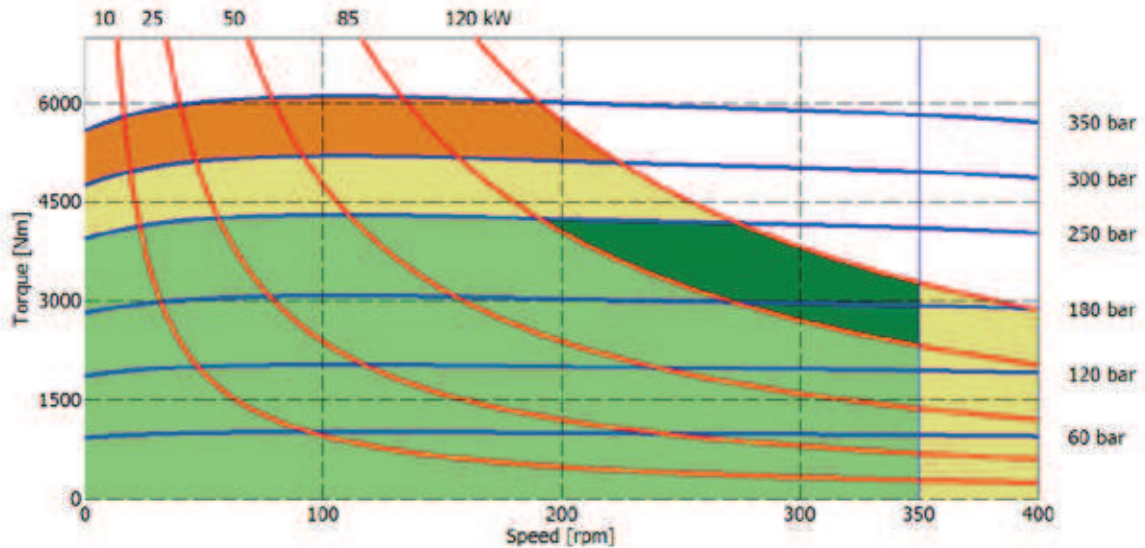

### 1400 cc

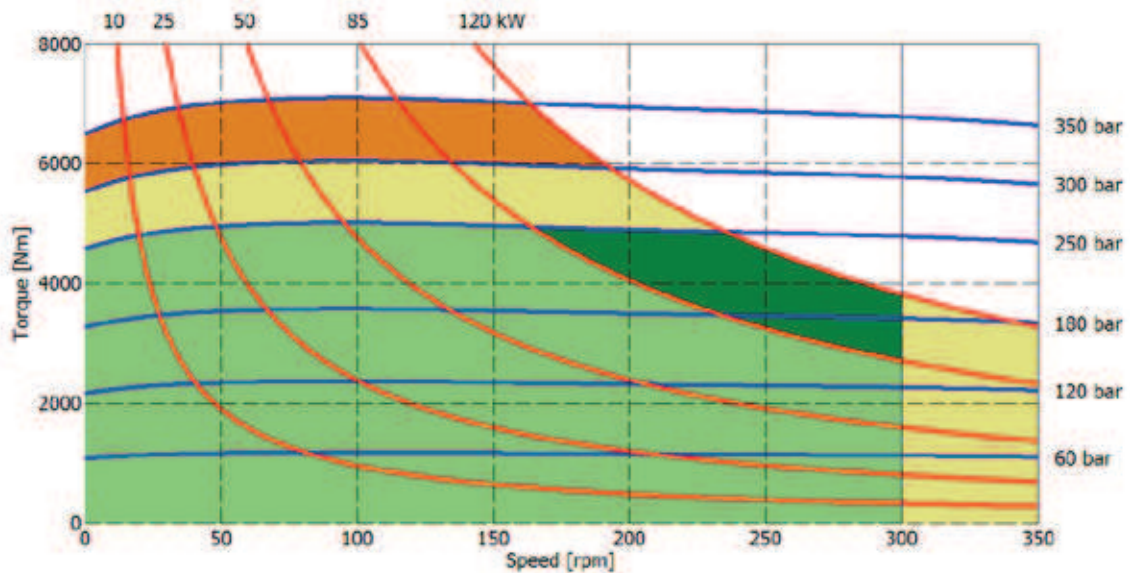

- Continuous operation
- Continuous operation with flushing or intermittent operation (see below for intermittent operation)
- Intermittent operation: permitted for a 15% of duty cycle, for 3 minutes maximum period
- Peak operation: permitted for very short periods (3-5 seconds every 10-15 minutes)

**The above diagrams are referring to the hydraulic motor working with a fluid in ideal conditions (viscosity at 40 cSt).** In case the working temperature increases and viscosity reach values under the recommended values (see hydraulic fluid recommendations) flushing must be performed or ISO oil grade must be changed. The working temperature must not overcome 70 °C.

The data specified into the catalogue are for product description purpose only and must not be interpreted as warranted characteristics in legal sense. Italgrou S.r.l. reserves the right to implement modifications without notice. All partial or total reproduction and copy without written authorization of Italgrou S.r.l. is strictly forbidden.



# IAM H45 - PERFORMANCE DIAGRAMS

## 1600 cc

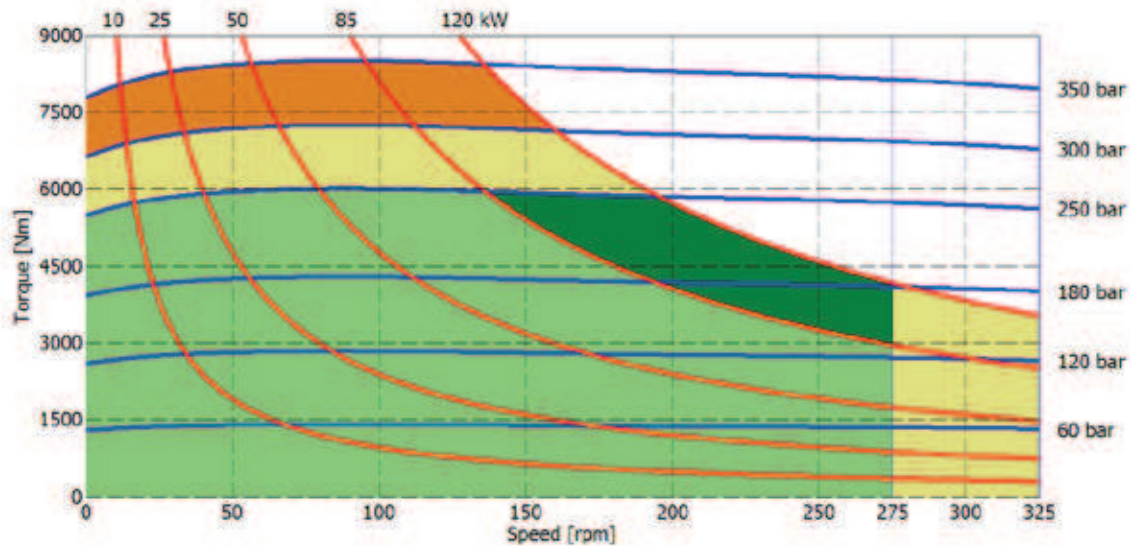

## 1800 cc

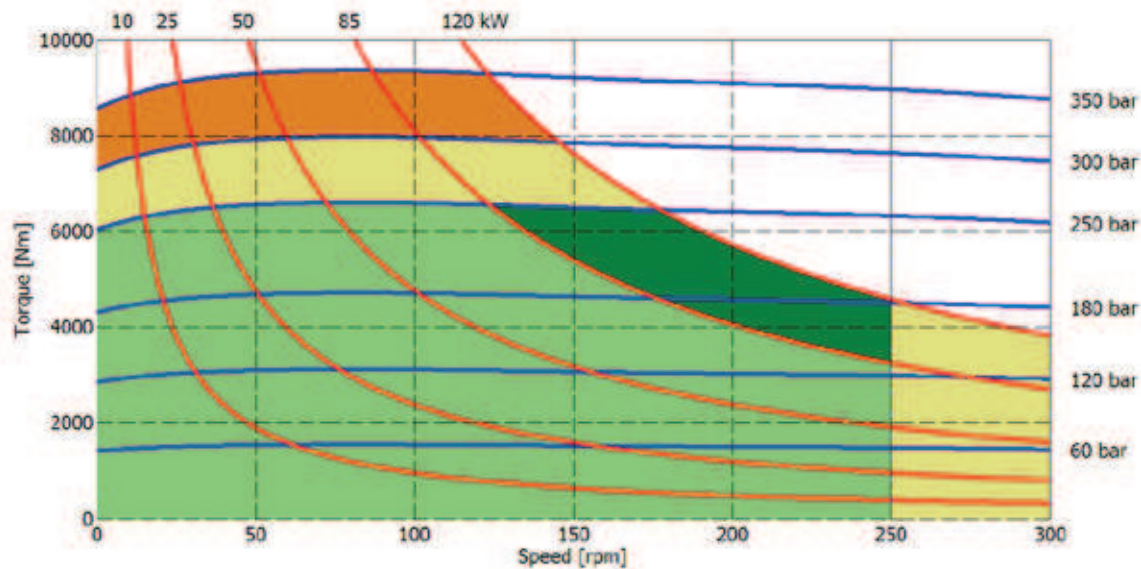

- Continuous operation
- Continuous operation with flushing or intermittent operation (see below for intermittent operation)
- Intermittent operation: permitted for a 15% of duty cycle, for 3 minutes maximum period
- Peak operation: permitted for very short periods (3-5 seconds every 10-15 minutes)

**The above diagrams are referring to the hydraulic motor working with a fluid in ideal conditions (viscosity at 40 cSt).** In case the working temperature increases and viscosity reach values under the recommended values (see hydraulic fluid recommendations) flushing must be performed or ISO oil grade must be changed. The working temperature must not overcome 70 °C.

The data specified into the catalogue are for product description purpose only and must not be interpreted as warranted characteristics in legal sense. ItalgrouP S.r.l. reserves the right to implement modifications without notice. All partial or total reproduction and copy without written authorization of ItalgrouP S.r.l. is strictly forbidden.

**BEARING LIFE**

Reference displacement 1400 cc

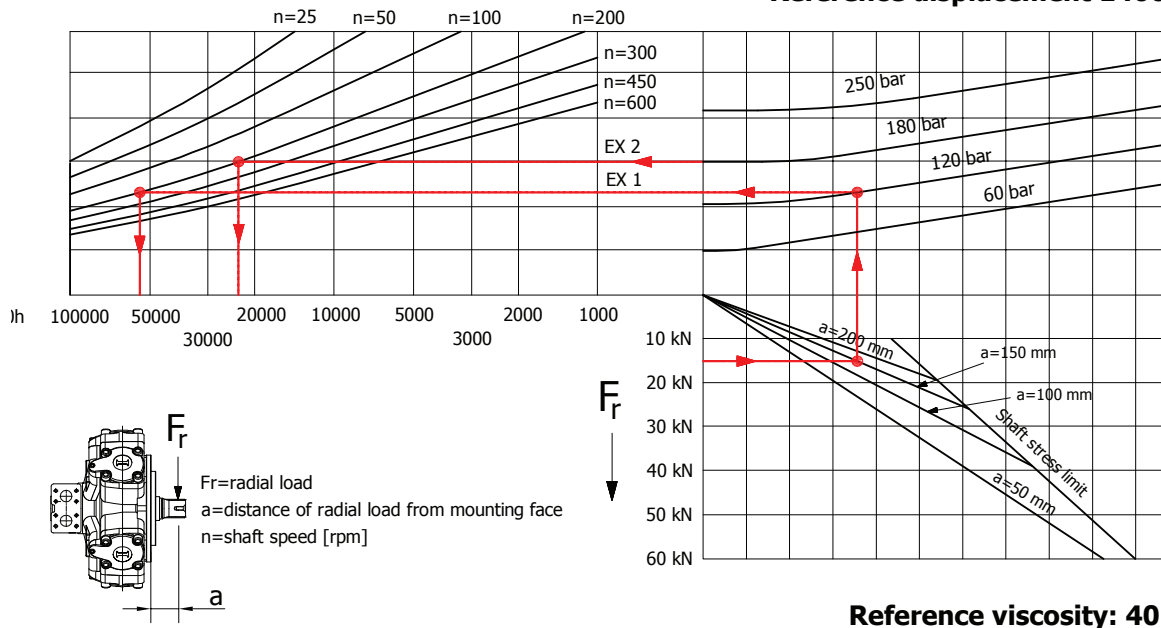

Example:

We suppose (EX2):  $p=180$  [bar],  $n=200$  [rpm]; we obtain an average lifetime of 22000 [h].

If we suppose (EX1):  $F_r=15$  [kN],  $a=150$  [mm],  $n=200$  [rpm] and  $p=120$  [bar] we obtain an average lifetime of 51000 [h].

The above data are referring to the IAM H45 series motors, displacement 1400 cc.



# IAM H45 - ORDERING CODE

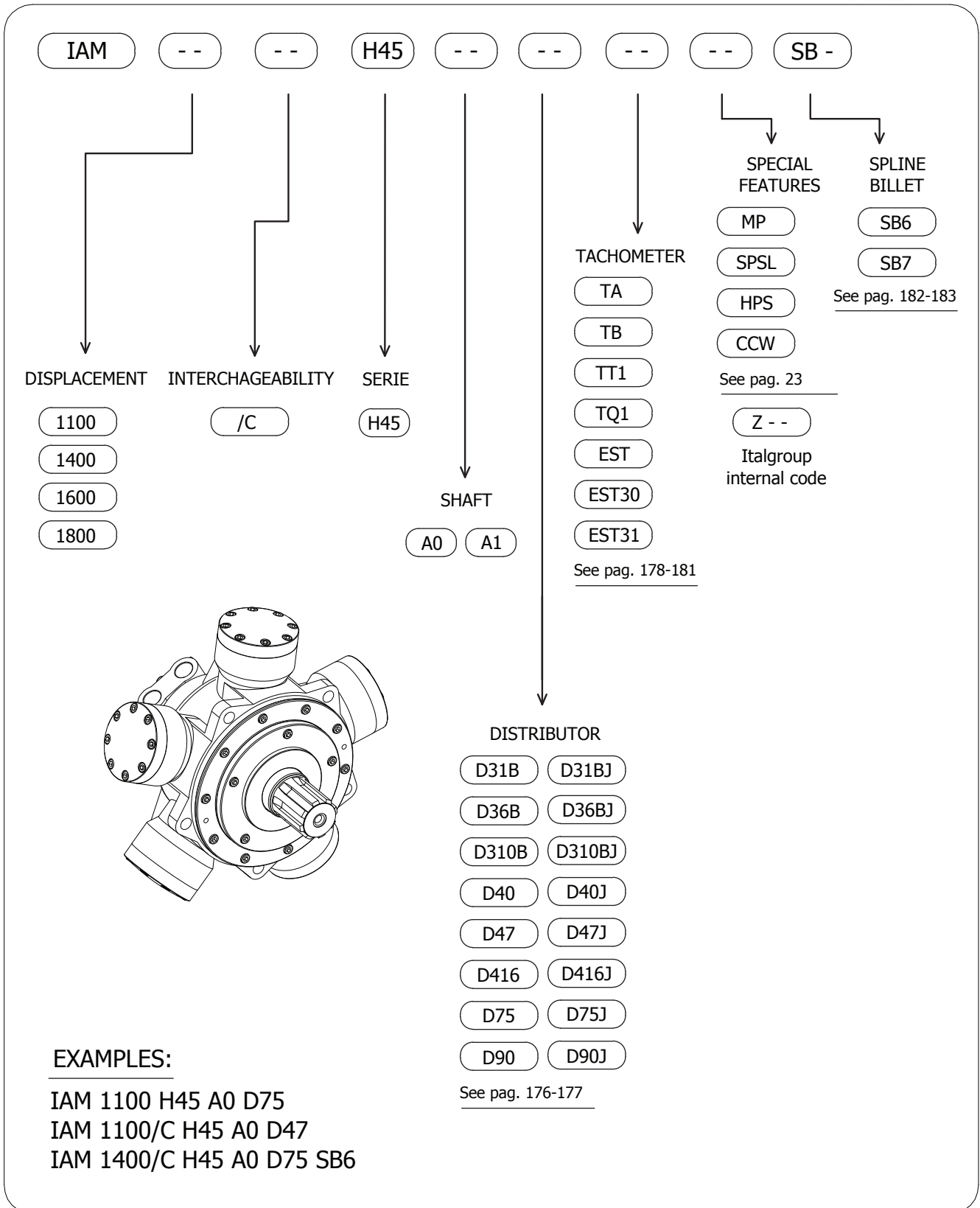

The data specified into the catalogue are for product description purpose only and must not be interpreted as warranted characteristics in legal sense. ItalgrouP S.r.l. reserves the right to implement modifications without notice. All partial or total reproduction and copy without written authorization of ItalgrouP S.r.l. is strictly forbidden.